



**Popes Grove
Twickenham**

£325,000

ChaseBuchanan

Key Features

- Viewings accompanied by Chase Buchanan
- Ground floor apartment
- Character features
- Large double bedroom
- Spacious reception room
- Direct access to the communal garden
- Share of Freehold
- Requires some updating
- Close to station & amenities
- Desirable location

Description

This charming, ground-floor conversion apartment in this well-maintained building has plenty of period features and is located on a desirable road in Strawberry Hill.

With a bright, neutral décor, the spacious living room leads into the kitchen and the large double bedroom has ample storage space. With lots of character and charm, with high ceilings and pretty coving and attractive fireplaces. Having direct access to the large, well-stocked communal garden, perfect for enjoying the warmer days.

Popes Grove is ideally located to take advantage of all that Strawberry Hill and Twickenham have to offer, from the delightful Radnor Gardens on the river to the ambient restaurants and charming riverside pubs and walks. Situated within easy access to both Richmond and Kingston with more comprehensive amenities. Commuter links are excellent with two stations providing direct services to London, Waterloo, frequent bus routes and easy access to the M3/M25 motorways and Heathrow Airport.





Popes Grove TW1

Approximate Gross Internal Floor Area = 51.8 sq m / 558 sq ft

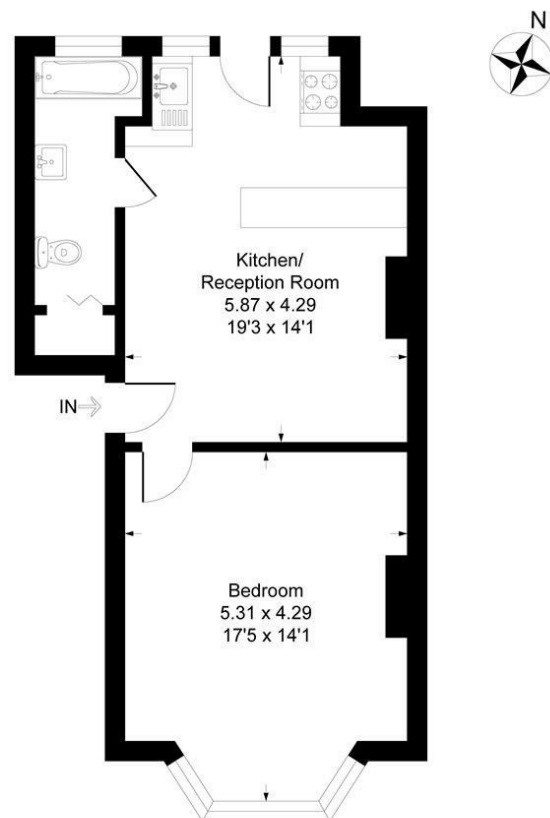
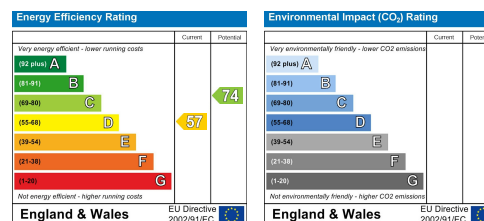

Illustration for identification purposes only, measurements are approximate, not to scale.

Care has been taken in the preparation of these particulars, however, their accuracy is not guaranteed and they do not form part of any contract. Measurements stated must be considered maximum.



For more information or to book a viewing, please contact:

020 8744 0101

twickenham@chasebuchanan.london

4 York Street, TW1 3LD

ChaseBuchanan